

LFF-040-310

Anchor Type

Diameter (mm)

Alloy Type

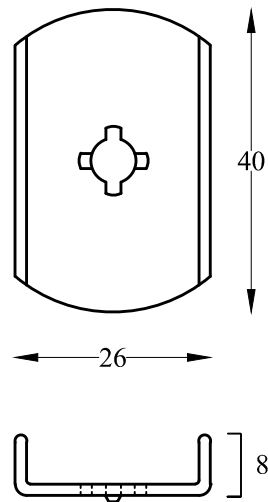

Thickness : 1.5 mm

Drowing Name: Lock Washer Fiber Fixing			Sign				
Drowing Number: RSD-1003		Drown: Salmani		Revision	Sign	Description	Date
Made From: Stainless Steel 310		Checked: Almasizadeh					
Scale: 1:1	Date: 99/11/25	Approved: Kahbassi					



RAH SANAT Refractories Co